

SITE PLAN

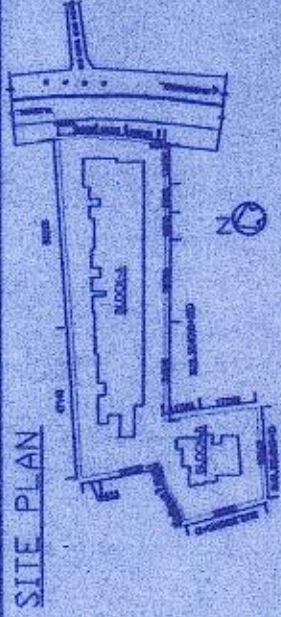

DECLARATION OF GEO-TECHNICAL ENGINEER
IT IS CERTIFIED THAT THE COMPREHENSIVE GEO INVESTIGATION HAS BEEN MADE BY ME FOR DESIGN & CALCULATION OF THE FOUNDATION OF THE BUILDING. THE FOUNDATION OF THE BUILDING IS FOUND TO BE SAFE IN ALL RESPECTS INCLUDING THE FOUNDATION OF THE STRUCTURE WILL BE CONSTRUCTED.

Tishara Kaban

TUSHARABARAN PASHARI
M.E. (Structural)
P-22, Purnima Park, Anand-34
Engineer M.C. No. G.T. 117

SIGNATURE OF GEO-TECHNICAL ENGINEER

CERTIFICATE OF ARCHITECTS
I/WE DO HEREBY CERTIFY THAT PLANS/ELEVATIONS AND SECTION DRAWINGS OF THE PROPOSED BUILDING AT C.S. OR R.S. NO. 83(P) & 87, CORRESPONDING L.R. NO. 2219(P) & 2218, AT MOUDA UDYANPUR, AND ALL NO. 43, IN WARD NO.12 AND HOUSING NO. 31 WITH SURROUNDING NEIGHBOURHOOD MUNICIPALITY, HAVE BEEN PREPARED IN CONFORMANCE WITH ALL RELEVANT PROVISIONS MUNICIPAL (BUILDING) REGULATIONS 2007 THIS ALSO TO CERTIFY THAT ALL RELEVANT * NO OBJECTION CERTIFICATE FROM THE RESPECTIVE AUTHORITIES AUTHORITY/POLLUTION CONTROL BOARD/TELECOMMUNICATION BOARD/STREET LIGHTING BOARD/SEWAGE TREATMENT PLANT TO CONSTRUCT/RECONSTRUCT/ADDITION TO ALTERATION OF THE BUILDING ON THE SMD PLOT.

V. Chaitanya
Architect
Office at Anand
No. CA/16/17/4

SIGNATURE OF ARCHITECTS

CERTIFICATE OF STRUCTURAL ENGINEER
I/WE DO HEREBY CERTIFY THAT THE FOUNDATION AND SUPER-STRUCTURE OF THE BUILDING HAVE BEEN DESIGNED BY ME TO BE SAFE IN ALL RESPECTS INCLUDING THE CONSIDERATION OF BEARING CAPACITY AND SETTLEMENT OF SOIL ETC. AS PER IS CODE.

SUMITA DEY
M.C.E. M.I.E. C.E.
152/17/98

SIGNATURE OF STRUCTURAL ENGINEER

CERTIFIED THAT I SHALL NOT ON A LATER DATE MAKE ANY ADDITION OR ALTERATION TO THIS PLAN AS PER RULES 1 AND 2 OF THE MUNICIPALITY AND ALSO ABIDE BY THOSE RULES DURING AND AFTER CONSTRUCTION OF THE BUILDING.

- 1. RISHI TRADCOM PRIVATE LIMITED
- 2. ASAL TRADCOM PRIVATE LIMITED
- 3. CHANGKEY DEALERS PRIVATE LIMITED
- 4. NIKHIL VINHAY PRIVATE LIMITED
- 5. POWERFUL TRADCOM PRIVATE LIMITED
- 6. ACTUAL COMMERCIAL PRIVATE LIMITED
- 7. LIFEMAKING INFRASTRUCTURE PRIVATE LIMITED
- 8. LOOKLURE DEANCOM PRIVATE LIMITED

SIGNATURE OF OWNER

PROJECT
PROPOSED B-G-61 STORED RESIDENTIAL BUILDING PLAN OF RISHIKOR BUILDWELL LP, NIKHIL VINHAY PRIVATE LIMITED & OTHERS IN C.S. OR R.S. NO. 83(P) & 87, CORRESPONDING L.R. NO. 2219(P) & 2218 AT MOUDA UDYANPUR AND L.R. NO. 43, IN WARD NO. 12 AND HOUSING NO. 31 WITH SURROUNDING NEIGHBOURHOOD MUNICIPALITY

ARCHITECT: THE DESIGN CELL
2A, COOPER STREET,
KOLKATA - 700 026

STRUCTURAL ELECTROMECHANICAL CONSULTANTS: DesignTree Services Consultants Pvt.Ltd
DesignTree
Consulting Engineers
1 Laxmi Nivasra Complex,
17 Phase, Bangalore 560 078, INDIA.
Email: info@designtree.com
www.designtree.com

CORPORATION DRAWING

DRAWING TITLE: G.A. AT GROUND & 1ST. FLOOR LEV.
SCALE: 1:100
DATE: 27.07.2018
CHECKED: SAMA BT
JOB NO: S-WDHAM-CORP-4-22 REV: 01

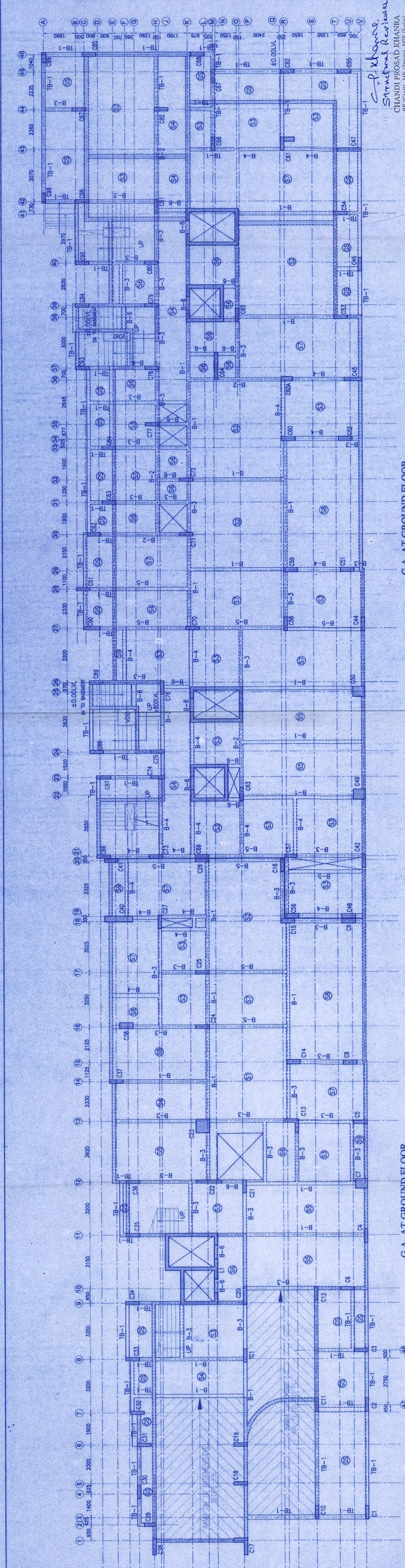

G.A. AT GROUND FLOOR

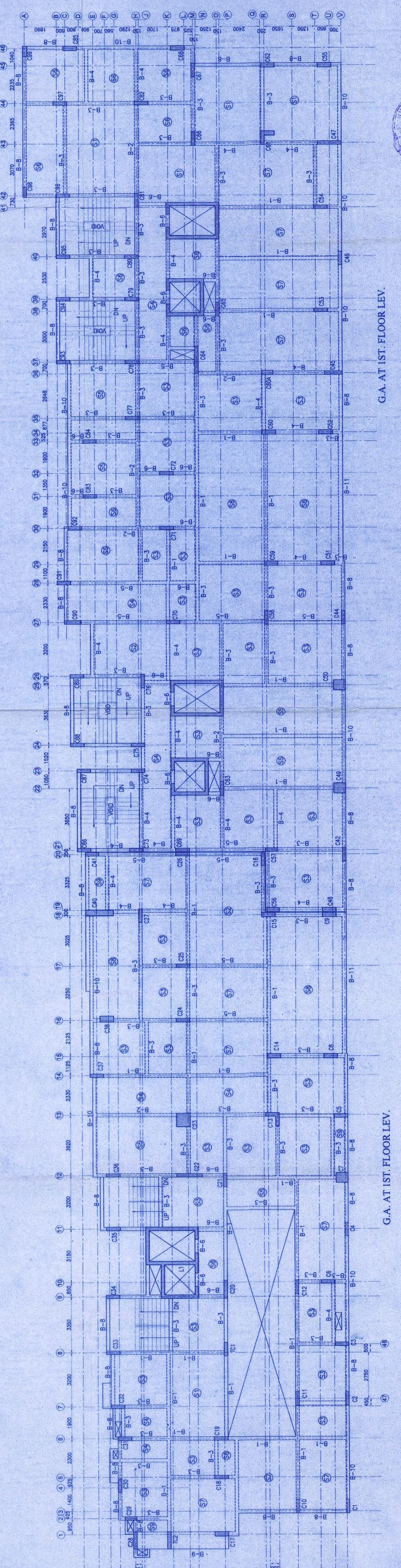

G.A. AT 1ST. FLOOR LEV.



G.A. AT 1ST. FLOOR LEV.